



Toaster oven MEO-10BDW-BK

Capacity: 10 Liter
220V-240V~ 50Hz/60Hz,
1000W



Before first using, please read the instruction manual carefully and keep it. The design and specifications of products are subject to change without prior notice due to the policy of continuous product upgrades.

Distributed by:

Midea Electric Trading (Singapore) Co. Pte Ltd
158 Cecil Street, #07-01/02 Singapore 069545

MEO-10BDW-BK
www.midea.com

IMPORTANT SAFEGUARDS

When using electrical appliance, basic safety precautions should always be followed, including the following:

1. Read all instructions before using.
2. To protect against any electrical hazards, DO NOT place unit or cord in water or any other liquids.
3. Do not touch any hot surfaces. Use oven mitts for removing or touching any hot parts. Always place Toast Oven on heat protected surface.
4. Leave about 100-150mm open space all around the exterior of this appliance. Place the appliance on a dry, horizontal surface.
5. Unplug the unit from outlet when not in use and before cleaning. Always allow to cool before attaching or removing any parts.
6. The use of accessory attachments not recommended by the appliance manufacturer may cause injuries.
7. Always pull the plug out from the wall – never pull the cord. Remove the plug from the wall before moving the appliance. Use both hands to move the appliance.
8. Do not let cord hang over edge of table or counter, or touch hot surface.
9. Do not place the Toaster Oven inside an heated oven or near a hot flame or electric burner.
10. Do not use outdoors
11. If the electric circuit is overloaded with other appliances, this appliance may not operate properly. The Toaster Oven should be operated on a separate electrical circuit from other operating appliances.
12. The temperature of accessible surfaces may be high when the appliance is operating.
13. If the supply cord is damaged, it must be replaced by the manufacturer or its service agent or a similarly qualified person in order to avoid a hazard.
14. Store only the accessories provided with this unit inside the oven when not in use. Do not store any other materials.
15. A fire may occur if the appliance is covered or touching flammable material, including curtains, draperies, walls, and the like, when in operation. Do not put any items on top of the appliance when in operation.
16. Do not place any cardboard, paper or plastic inside the oven.
17. All containers placed inside the oven must not be airtight. Also, they need to have enough room to allow for expansion of fluids.
18. Clean this appliance regularly as build – up of grease may cause a fire. Make sure that this appliance is not placed near curtains, any drapery, or other flammable material.
19. Do not clean with metal scouring pads. Pieces can break off the pad and touch electrical parts involving a risk of electric shock.
20. In order to prevent accidental burns, always use the handle and knobs to operate this appliance.
21. The temperature of the door or outer surface may be high when the appliance operating.

22. Oversize foods or metal utensils must not be inserted in a toast oven as they may create a fire or risk of electric shock.
23. Do not cover crumb tray or any part of the oven with metal foil. This will cause overheating of the oven.
24. Extreme caution should be exercised when using containers constructed of other than metal or glass.
25. This appliance is not intended for use by persons (including children) with reduced physical, sensory or mental capabilities. Or lack of experience and knowledge unless they have been given supervision or instruction concerning use of the appliance by a person responsible for their safety.
26. Children should be supervised to ensure that they do not play with the appliance.
27. The appliance is not intended to be operated by means of an external timer or separate remote-control system.
28. The rear surface of appliance shall be placed against a wall.



Caution :hot surface

SAVE THESE INSTRUCTIONS HOUSEHOLD USE ONLY

BEFORE FIRST USE

1. Remove all accessories and shipping materials packed inside the Oven.
2. Wash the Rack and Pan in warm soapy water. Wipe the inside of the Oven with a damp cloth or sponge. Blot dry with paper towels to be sure the unit is dry before using.
3. Place Oven on a flat counter or other stable surface **DO NOT OPERATE ON THE SAME CIRCUIT WITH ANOTHER APPLIANCE.**
4. Make sure the Crumb Tray is properly installed before using.

For the first time only, Set the function setting on toast and the timer to 15 minutes. This will burn off any oils still on the oven.



NOTE: The oven may smoke during this process. This is normal for a new oven and will not last more than 10-15 minutes.

NAME OF PARTS

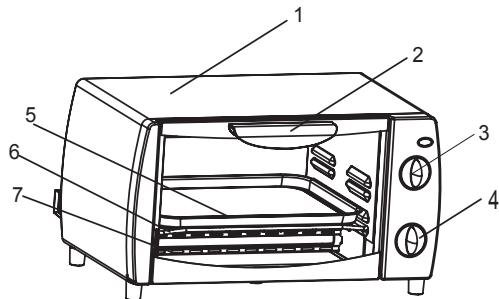
1. Housing
2. Door handle
3. Function Knob
4. Timer Knob
5. Baking/Broiling Pan
6. Baking Rack
7. Crumb Tray



HOW TO USE

1. Rotate the Function knob clockwise to "  " position. Open the Oven Door and place the bread slice on the Baking Rack. Place 1 slice of bread in the center of baking rack, 4 slices side by side.
2. When setting in "  ", both the heating elements will work.
3. The most length of time you want to toast for 7minutes.

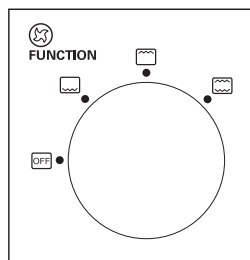

BROILING

1. Slide in the Baking tray under the rack. Always use the baking tray when broiling the food like chicken wings or drumstick which contains fat.
2. Place food on the Baking rack.

When setting in "  ", only top heating element will work.

NOTE – We always suggest preheating oven about 3-5 minutes before placing the food.

3. Rotate the function knob clockwise to "  " position.
4. The Timer Knob is the on/off switch
5. For short time rotate the timer knob clockwise (up to 15 minutes), when the cycle is finished, the bell will ring and the power is automatically turned off.

NOTE – Always monitor the food at this setting to prevent overcooking. Overturn the food during the process or add the flavoring if necessary. Always use oven mitts to prevent the risk of scalding.

BAKING

1. Slide the Baking tray into the bottom rack level.
2. Place food on the baking tray.

When setting in "  ", only bottom heating element will work.

NOTE – We always suggest preheating oven 5 minutes at this setting before place the food.

3. Rotate the function knob clockwise to "  " position
4. Setting the time based on the food type, thickness. The heating element will be cycled on and off to maintain the constant cavity temperature. The maximum time can be set by timer is 15 minutes, for longer time over 15 minutes you must set the timer to "STAY ON" position. In this case you must stop the oven manually by turning the timer knob to "OFF" position once the food is done.

NOTE – Always monitor the food at this setting to ensure that you are not overcooking.

Time Setting:

Choose your crust preference by adjusting the timer knob clockwise to select toasting time. To test the toasting of your type of bread, we suggest starting at short time, as bread varies according to humidity, thickness and texture, each type of bread will toast differently according to these properties.

NOTE: when setting the timer knob for less than 5 minutes, always rotate timer to over 10 minutes and then rotate back to your chosen time. This will ensure a safe and accurate timer setting.

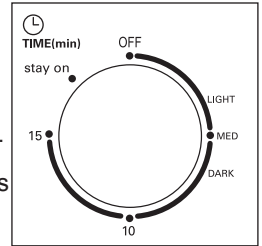

STAY ON

For use the toaster without time control, turn the timer knob to position " Stay on" In this case, the toaster will work until the timer knob is set to " off" position.

Note: the bread may catch fire if the toasting time is setting too long. Close supervision is necessary during toasting and the timer do not being set too long.

ABOUT RACK LEVELS

There are 2 rack levels. The baking tray or rack can be slid into the groove for either level.

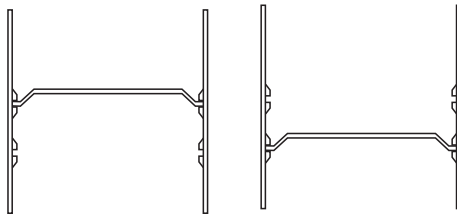

CARE AND CLEANING

1. Before cleaning unplug the toaster oven and allow it to cool completely.
2. Wash all the attachments with mild, soaped water including the rack and the baking Tray.
3. Do not use abrasive cleansers, scrubbing brushes and chemical cleaner as this will cause damage to the non-stick coating of baking Tray.
4. Using a wet cloth to wipe the inner of the oven.
5. To clean the door by using a wet cloth saturated with detergent or soap.
6. Never immerse the unit in water or other liquid.
7. Any other servicing should be performed by an authorized service representative.

Cleaning the Bottom of the Crumb Tray

This appliance has a drop open crumb tray at the bottom of the baking chamber. First unplug this appliance and allow cooling.

To clean out the crumbs, simply tilt the unit backwards and push the Crumb Tray Slide Fastener towards the rear, down allow dropping on counter top.

Wipe interior of crumb tray with a damp cloth. After cleaning, slide the "Crumb Tray Slide Fasteners" into the tabs to lock the crumb tray.

Washing of the interior of the crumb tray is accomplished by placing unit on its back side and allow crumb tray to fall forward for easy cleaning.

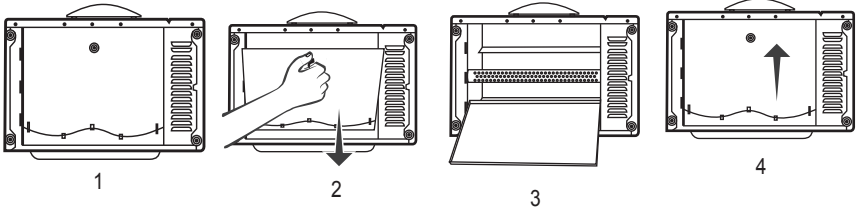



make yourself at home